



CEMBRE

BATTERY OPERATED HYDRAULIC CRIMPING TOOL

B1500

B1500A

B1500E

B1500YA

CE

UK
CA



ENGLISH

OPERATION AND MAINTENANCE MANUAL
(Translation of the original instructions)

22M283E - 6261390

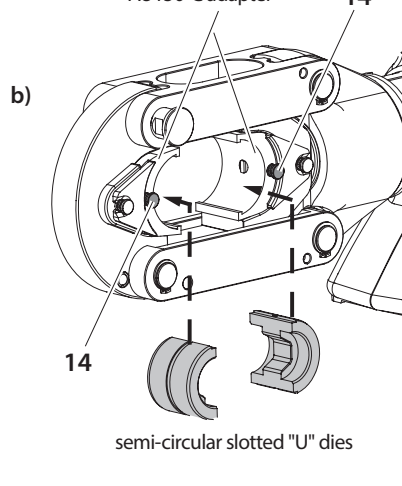
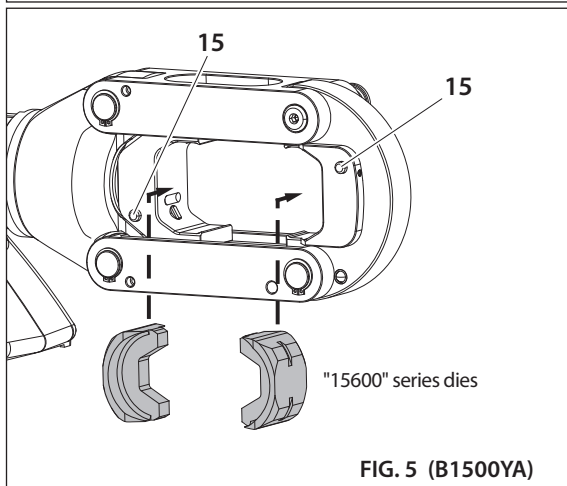
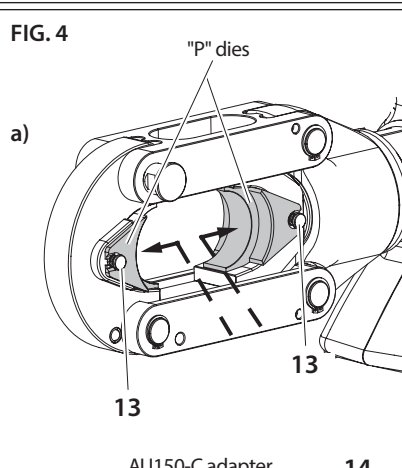
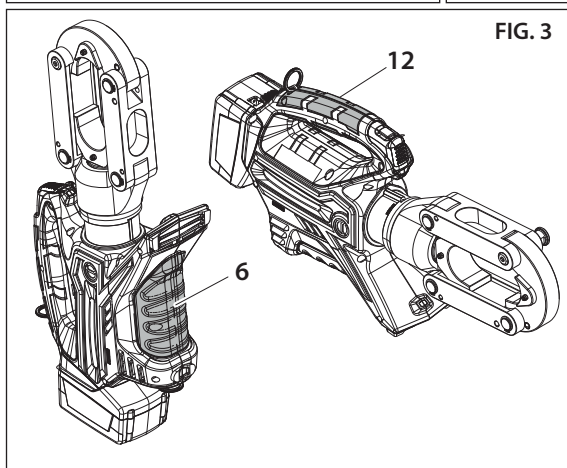
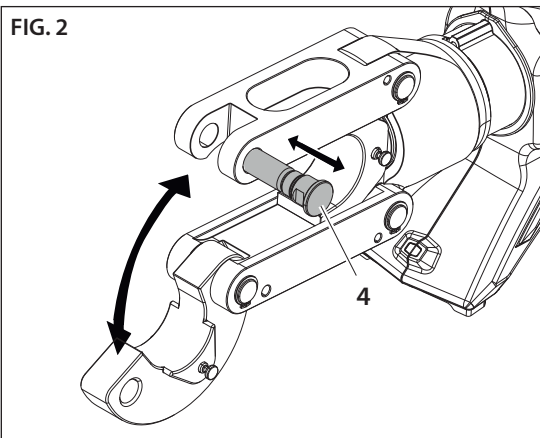
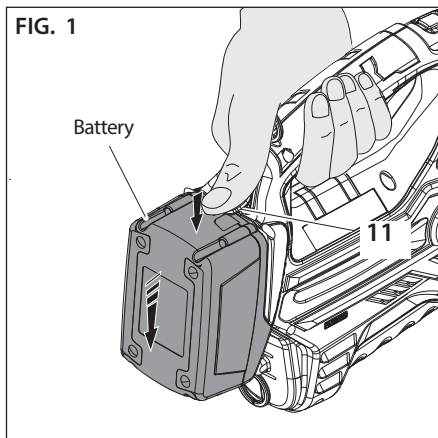

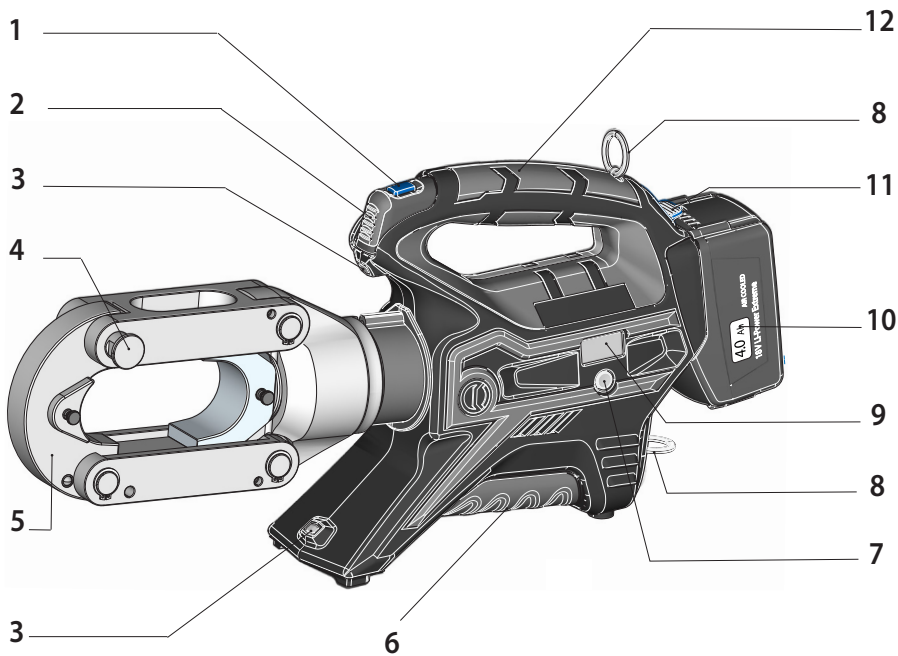





FIG. 6

1	OPERATING BUTTON
2	PRESSURE RELEASE BUTTON
3	LED WORKLIGHT
4	OPENING HEAD PIN
5	OPENING HEAD
6	HANDLE
7	TOUCH BUTTON FOR MENU SELECTION
8	RING FOR SHOULDER STRAP
9	DISPLAY
10	BATTERY
11	BATTERY RELEASE
12	HANDLE

WARNING SYMBOLS

Tool:

 <p>Before using the tool, carefully read the instructions in this manual.</p>	 <p>When operating the tool, keep hands away from the danger zone.</p>	 <p>Do not operate when dies are not in place.</p>
---	---	---



Following information applies in member states of the European Union:

USER INFORMATION in accordance with "Directives 2002/95/EC and 2002/96/EC. The 'Not in the bin' symbol above when shown on equipment or packaging means that the equipment must, at the end of its life, be disposed of separately from other waste.

The separate waste collection of such equipment is organised and managed by the manufacturer.

Users wishing to dispose of such equipment must contact the manufacturer and follow the prescribed guidelines for its separate collection. Appropriate waste separation, collection, environmentally compatible treatment and disposal is intended to reduce harmful environmental effects and promote the reuse and recycling of materials contained in the equipment. Unlawful disposal of such equipment will be subject to the application of administrative sanctions provided by current legislation.

Battery:

 <p>Always recycle the batteries.</p>	 <p>Never throw batteries into fire or water.</p>	 <p>Do not discard batteries into domestic refuse or waste disposal.</p>
--	--	---

1. GENERAL CHARACTERISTICS

		B1500	B1500A	B1500E	B1500YA
Application range		suitable for installing electrical compression connectors for Copper conductors up to 1500 MCM (800 sqmm) and for Aluminum conductors up to 1250 MCM (625 sqmm).			
Type of acceptable dies:		accepts all "P" type dies commonly used in industry and the semi-circular slotted dies (U-dies) common to most 12 ton tools and 14,6 ton Cembre tools.		accepts all "15600" series dies commonly used in industry	
Rated crimping force	kN (US sh. ton)	136 (15.3)			
Minimum crimping force	kN (US sh. ton)	134,3 (15.1)			
Minimum operating pressure	bar (psi)	742 (10762)			
Dimensions (Fig. 7 page 14)	mm (inches)	525 x 251 x 102.5 (20.6 x 9.9 x 4)			
Weight with battery	kg (lbs)	9,7 (21.3)			
Motor	V ~	18			
Operating temperature	°C (°F)	-15 to +50 (+5 to +122)			
Recommended oil		ENI ARNICA ISO 32 or equivalents			
Operating speed		twin speed operation and automatic switching from a rapid advancing speed of the ram to a slower, more powerful crimping speed			
Safety		maximum pressure valve			
Rechargeable battery	type	CB1852L Li-Ion			
	V / Ah (Wh)	18 / 5,2 (93,6)			
Weight	kg (lbs)	0,66 (1.45)			
Acoustic noise ⁽¹⁾	dB	L _{pA} 66,9 (A)	L _{pCPeak} 86,9 (C)	L _{WA} 74,9 (A)	
Vibrations ⁽²⁾	m/s ²	0,398			

⁽¹⁾ Directive 2006/42/EC, annexe 1, point 1.7.4.2 letter u

L_{pA} = weighted continuous acoustic pressure level equivalent.

L_{pCPeak} = maximum value of the weighted acoustic displacement pressure at the work place.

L_{WA} = acoustic power level emitted by the machine.

⁽²⁾ Directive 2006/42/EC, annexe 1, point 2.2.1.1

Weighted root mean square in frequency of the acceleration the upper limbs are exposed to for each biodynamic reference axis. Tests carried out in compliance with the indications contained in EN ISO 5349-1/2 and Standard, and under operating conditions much more severe than those normally found.

		B1500	B1500E	B1500A	B1500YA
Battery charger	type	ASC55-EU	ASC55-UK	ASC30-36-USA/CA	
Input	V / Hz (W)	220 - 240 / 50 - 60 (85)		115 / 60 (85)	

WARNING



Do not use the tool for purposes other than those intended by CEMBRE. The operator should concentrate on the work being performed and be careful to maintain a balanced working position.



Before starting work on electrical equipment, please ensure that either there are no live parts in the immediate working area or that precautions are taken for working near live parts in accordance with EN50110-1.



Do not use this tool on or near energised conductors without proper personal protective equipment. Failure to observe this warning could result in severe injury or death.



The tool is unsuitable for continuous use and should be allowed to cool down following uninterrupted, successive crimping operations; for instance, having exhausted a fully charged battery in one session, delay battery replacement for a few minutes.



Protect the tool from rain and moisture. Water will damage the tool and battery. Electro-hydraulic tools should not be operated in pouring rain.

2. INSTRUCTIONS FOR USE



IMPORTANT: *Never pressurise the tool without inserting the dies, this could cause damage to the head and the ram.*

The part reference includes the following:

- ▶ Hydraulic crimping tool.
- ▶ Li-Ion rechargeable battery (2 pcs).
- ▶ Battery charger (model depends on the tool version).
- ▶ Shoulder strap.
- ▶ Metal carrying case.
- ▶ USB cable (Ref. to § 6 page 13).

2.1 Preparation

The tool can be easily carried using either the main handle (12) or the shoulder strap attached to the two rings (8) (Ref. to Fig. 6).

The main operating positions are: horizontal standing on its feet and vertical standing on its battery. In addition to the main handle (12) the lower handle (6) allows a safer and more balanced grip when using two hands to hold the tool (Ref. to Fig. 3).



Before starting any work, check the battery charge (Ref. to § 2.8) and recharge if necessary, following the instructions in the battery charger user manual.

- ▶ To replace the battery, grip the tool as illustrated in Figure 1; press the release button (11) and push the battery downward unlocking it.
Insert a charged battery from the bottom by sliding it into the guides until it locks.
- ▶ The display shows the operational parameters of the tool; to customise them proceed as described in § 2.7.
- ▶ Select the appropriate die set for the connector to be crimped and insert them into the tool head as described in § 3.



When introducing or changing dies, the battery must first be removed from the tool.

- ▶ Insert the conductor into the connector and position the connector between the die; if necessary open the tool head by means the locking pin (4) (Ref. to Fig. 2).
- ▶ Ensure the correct location of the crimp.

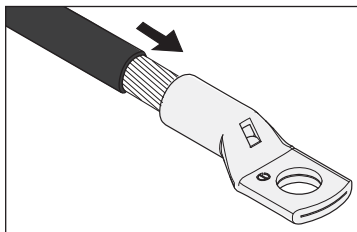

NOTE: when more compression is required, proceed according to the sequence and direction indicated in the figure, uniformly spacing the compressions.

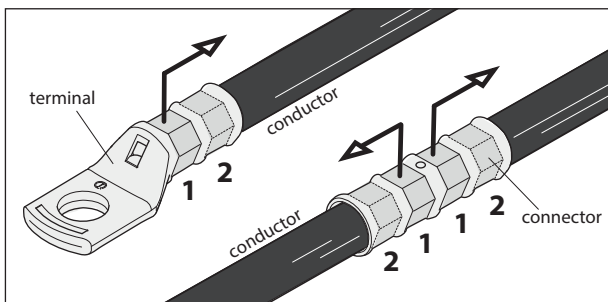

Before carrying out further crimping operations make sure the locking pin (4) is completely inserted: its partial insertion may damage the tool head.

2.2) Die advancement

- ▶ Press operating button (1) to activate the motor-pump and advance the lower die.
- ▶ To halt the advancement, release operating button and the motor will cut out.

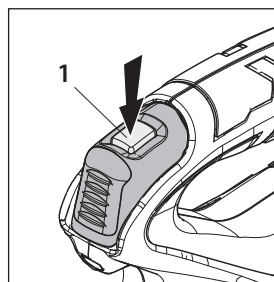

Make sure the dies are exactly positioned on the desired crimp point otherwise re-open dies following instructions as per § 2.4 and reposition the connector.

2.3) Compression

- ▶ By keeping operating button (1) pressed, the motor continues to operate: the ram will gradually move forward until the two dies touch.
- ▶ The motor will stop automatically when the set pressure has been reached.



To perform proper compression, press and hold the operating button (1) until the motor stops automatically.

NOTE: To display the momentary force or pressure during the work cycle, select the appropriate display from the menu (Ref. to § 4). When the operating button is released before the motor stops automatically, the display will show the peak force (F_p) or the peak pressure (P_p) reached at that instant.

$F_m = 134.3 \text{ kN}$
 $F_p = 102.3 \text{ kN}$

$F_m = 134.3 \text{ kN}$
OK

$P_m = 742 \text{ bar}$
 $P_p = 565 \text{ bar}$

$P_m = 742 \text{ bar}$
OK

To complete the work, press the operating button again until the motor stops automatically; the display will show the maximum force or pressure reached followed by 'OK' to confirm correct operation.



The display 'ERROR', combined with a beep and the LEDs flashing, indicates an incorrect crimping procedure caused by the work cycle being interrupted before the control parameters (force/pressure) of the tool are reached. This error appears when the pressure release button has been operated and the tool has already reached a pressure > 100 bar. In this case, repeat the compression by pressing and holding the operating button until the motor stops automatically.



This error appears when the pressure release button has been operated and the tool has already reached a pressure > 100 bar. In this case, repeat the compression by pressing and holding the operating button until the motor stops automatically.

2.4) Release of dies

- ▶ By operating the pressure release button (2), the ram will retract and open the dies.
- ▶ To take the dies off their guide, it is sufficient to press the pins and slip them from the head (Ref. to Fig. 4 and 5).

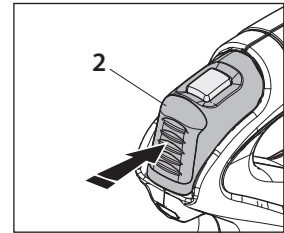

2.5) LED Worklights

Whilst the tool is in operation, the compression area is illuminated by two high luminosity LED Worklights that switch off automatically at the end of the cycle.



The LED Worklights can be disabled by following the procedure described in § 4.2.

2.6) Head rotation

For ease of operation, the tool head can rotate through 180°, allowing the operator to work in the most comfortable position.



Do not attempt to rotate the head when the hydraulic circuit is pressurised.

2.7) Capacitive touch button for menu selection

This button is located under the display and allows selection of various screens (Ref. to § 4); it only works when the display is on.

Wearing gloves or using other objects may inhibit the operation of the button, therefore use a bare finger to apply only a light touch.



Do not apply pressure to or stab at the touch button, a light touch using a bare finger is sufficient. The command pulse is sent when the finger releases the button.

2.8) Battery status

- ▶ The battery is equipped with LED indicators that show the remaining battery life at any time by pressing the adjacent button (P):
 - 4 LEDs illuminated: fully charged
 - 2 LEDs illuminated: 50 % capacity
 - 1 LED flashing: minimum charge, replace the battery.
- ▶ With the battery inserted into the tool, the remaining battery life can also be checked on the display, via touch button selection (Ref. to § 4).

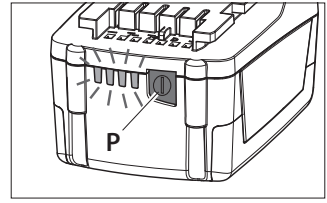

The screen shown alongside indicates that the battery voltage has dropped below a minimum safety threshold; under these conditions the tool will not start, and it is necessary to recharge or replace the battery.

The approximate time to fully recharge a battery is about 100 minutes.



2.9) Using the battery charger

Carefully follow the instructions in the battery charger user manual.

3. DIE AND ADAPTER ASSEMBLES

B1500, B1500A and B1500E tools directly accept all "P" type dies commonly used in industry and when used with adapter AU150-C (optional accessory) will accept semi-circular slotted dies (U-dies) common to most 12 ton tools and 14,6 ton Cembre tools. Depending on the dies to be used, please proceed as follows:

3.1) Use of "P" dies (Ref. to Fig. 4a)

- ▶ Press pins (13) and insert half of the "P" die into the upper seat of the head and the other half into the lower seat of the ram; to disassemble them press the pins (13) and slip them from the head.

3.2) Use of semi-circular slotted dies ("U" dies) (Ref. to Fig. 4b)

- ▶ Insert the 2 parts of the AU150-C adapter following the instructions as § 3.1.
- ▶ Select the appropriate "U" die set for the connector to be crimped.
- ▶ Press pins (14) and lock the parts of the "U" dies into the upper and lower parts of the AU150-C.

3.3) Use of "15600" series dies (Ref. to Fig. 5)

B1500YA tool directly accepts the "15600" series dies commonly used in industry.

- ▶ Select the appropriate "15600" die set for the connector to be crimped.
- ▶ Press pins (15) and lock one die into the upper seat of the head and the other die into the lower seat of the ram; to disassemble them press the pins (15) and slip them from the head.

4. DISPLAY

The OLED display switches on automatically when the operating or pressure release buttons are pressed, and off after 60 seconds of non-operation.

The display shows:

- ▶ The main operational parameters of the tool processed by the circuit board, such as peak pressure or force reached.
- ▶ Information on the condition of the tool, such as the charge level, the battery temperature and maintenance requirements.
- ▶ Any operational or procedural ERRORS.

Use the touch button (8) to navigate through the menu screens to manage INFORMATION AND SELECTION:

4.1) INFORMATION SCREENS: display a pre-determined parameter which will then appear each time the tool is started and during the entire work cycle.

F_m = 134.3 kN
F_p = 94.5 kN

F_m: Minimum set force, expressed in kN.
F_p: Peak force reached, expressed in kN,
(screen as factory setting).



F_m = 15.1 ton
F_p = 10.61 ton

F_m: Minimum set force, expressed in USA sh. tons.
F_p: Peak force reached, expressed in USA sh. tons.



P_m = 742 bar
P_p = 522.3 bar

P_m: Minimum set pressure, expressed in bar.
P_p: Peak pressure reached, expressed in bar.



P_m = 10762 psi
P_p = 7575 psi

P_m: Minimum set pressure, expressed in psi.
P_p: Peak pressure reached, expressed in in psi.



Battery charge level.



1000
-29000

No. of cycles performed.
No. of cycles before scheduled recommended maintenance.



B1500
NR 14AZ541

Cembre logo, tool model.
Tool serial no



To make a selected screen operational and appear at each start-up of the tool, operate the touch button for at least 3 seconds; a continuous beep will confirm the setting.



The capacitive menu selection button may not work if touched using objects or when wearing gloves, therefore always operate it using a bare finger.

4.2) SELECTION SCREENS: control parameters that cannot be set as automatic upon start-up of the tool, can be changed by operating the touch button:

Enabling/disabling the LED Worklights (factory setting LED ON)

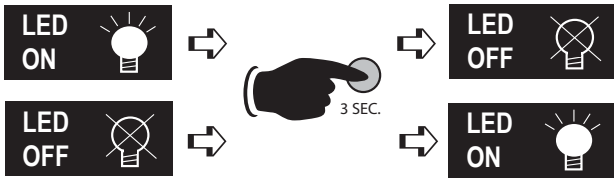

When the screen is displayed, touch the button for at least 3 seconds to deactivate for reactivate operation of the LED Worklights during tool use; a continuous beep will confirm the setting.

Return to original factory settings / firmware version

When the 'RESET' screen is displayed, return the tool to its factory setting by operating the touch button for at least 3 seconds; a beep will confirm the setting.



The RESET screen also shows the firmware version of the circuit board.

4.3) WARNINGS: these appear during operation and notify the operator of the status of the tool:



LOW BATTERY: replace the battery.

NOTE: when the battery Vage falls below a minimum safety threshold, the tool will not start; although it is still possible to end the work cycle in progress.



BATTERYTEMPERATURE HIGH: remove the battery and wait until it cools down.









NO. OF CYCLES TO MAINTENANCE REACHED:

the tool continues to work however, it is recommended that it is sent to CEMBRE for a complete overhaul (see § 7).

NOTE: this message, together with a beep, will reappear when the tool has been idle for 30 seconds.

4.4) ERRORS: these appear during operation, combined with a beep and flashing LED Worklights, to notify the operator of procedural or operational errors.

Message	Error description	Solution
	The pressure release button (2) was pressed before the control parameters were reached (Force/Pressure).	Repeat the work cycle and wait for the motor to stop automatically.
	Interruption of the signal from the NTC temperature probe of the battery.	Replace the battery. If the problem persists, please contact CEMBRE.
	Abnormal power consumption of the motor for more than 3 seconds. The tool stops.	Wait for the display to turn off (60 sec.) or remove and re-insert the battery, then re-start the tool. If the error occurs frequently, contact CEMBRE.
	Output voltage of the pressure transmitter is out of the pre-set range.	Repeat the work cycle; if the error occurs frequently, contact CEMBRE.
	Failure to reach the set pressure within 30 seconds of continuous operation of the machine.	Repeat the work cycle; if the error occurs frequently, contact CEMBRE.
	Overcharging of the battery with protection tripping. The tool stops.	Wait for the display to turn off (60 sec.) or remove and re-insert the battery, then re-start the tool. If the error occurs frequently, contact CEMBRE.

 *Errors are displayed for about 30 seconds before being reset, but will display repeatedly in the event of permanent anomalies.*

5. MAINTENANCE

The tool is robust, completely sealed, and requires very little daily maintenance. Compliance with the following points, should help to maintain its optimum performance:

5.1) Thorough cleaning

Dust, sand and dirt are a danger for any hydraulic device.

Every day, after use, the tool must be wiped with a clean cloth taking care to remove any residue, especially close to pivots and moveable parts.

Do not use hydrocarbons to clean the rubber parts.



5.2) Storage case

When not in use, the tool should be stored and transported in the metal case, to prevent damage.

Metal case: VAL-B1500, size 565x410x132 mm (22.2x16.1x5.2 in.), weight 6,7 kg (14.7 lbs).

6. CONNECTION TO COMPUTER (Smartool technology)

The memory card integrated in the tool records operating data for transfer via the USB cable supplied.

To view and manage this data, go to www.cembre.com and register in the dedicated area, then download the free CEMBRE software **CEM_SWBT01**.

Keeping the Firmware of the tool updated, via free of charge download from here, will optimise the tool's performance.



7. RETURN TO Cembre FOR OVERHAUL

In the case of a breakdown contact our Area Agent who will advise you on the problem and give you the necessary instructions on how to dispatch the tool to our nearest service Centre; if possible, attach a copy of the Test Certificate supplied by CEMBRE together with the tool or fill in and attach the form available in the "ASSISTANCE" section of the CEMBRE website.

FIG. / BILD 7

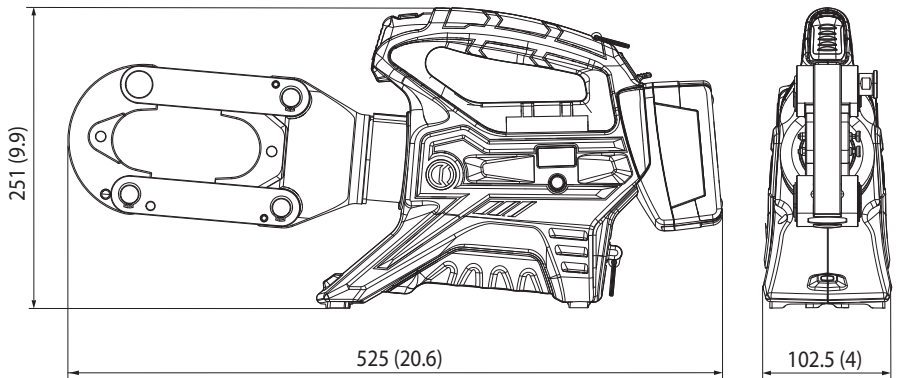

mm (inch)

NOTE



**DECLARATION OF CONFORMITY -
DECLARATION DE CONFORMITE - KONFORMITÄTSERKLÄRUNG -
DECLARACIÓN DE CONFORMIDAD - DICHIARAZIONE DI CONFORMITÀ**

We Nous Wir Nos Noi: **CEMBRE S.p.A. Via Serenissima, 9 – 25135 Brescia (Italy)**

Declare under our sole responsibility that the product - *Déclarons sous notre seule responsabilité que le produit*
- Erklären in alleiniger Verantwortung dass das Produkt - *Declaramos bajo nuestra responsabilidad que el producto*
- Dichiariamo sotto nostra unica responsabilità che il prodotto:

B1500 B1500A B1500E B1500YA

To which this declaration relates is in conformity with the following standard(s) or other normative document(s)
Auquel cette déclaration se réfère est conforme à la (aux) norme(s) ou autre(s) document(s) normatif(s) -
Auf dass sich diese Erklärung bezieht, mit der/den folgenden Norm(en) oder dem/den normativen Dokument(e)
über einstimmt - *Al que se refiere esta declaración, cumple la(s) norma(s) u otro(s) documento(s) normativo(s)* -
Al quale si riferisce questa dichiarazione è conforme alla(e) norma(e) o altro(i) documento(i) normativo(i):

EN ISO 12100 EN ISO 3744 EN ISO 11202 EN ISO 5349-1 EN ISO 5349-2 EN55014-1/A11 EN 55014-2

Following the provisions of EU directive(s) - *Conformément aux dispositions de(s) directive(s) EU* -
Gemäß den Bestimmungen der EU Richtlinien - *De acuerdo con las disposiciones de la(s) directiva(s) EU*
Conformemente alle disposizioni della(e) direttiva(e) EU:

2006/42/EC 2011/65/EU 2014/30/EU

Person authorised to compile the technical file - *Personne autorisée à constituer le dossier technique* -
Person die bevollmächtigt ist, die technischen Unterlagen zusammenzustellen -
Persona facultada para elaborar el expediente técnico - Persona autorizzata a costituire il file tecnico:

Gianluca Cama via Serenissima, 9 – 25135 Brescia (Italy)

Brescia 27-10-2022



CEMBRE

Felice Albertazzi
CHIEF SALES & MARKETING OFFICER
Cembre S.p.A.



DECLARATION OF CONFORMITY

We: **CEMBRE S.p.A. Via Serenissima, 9 – 25135 Brescia (Italy)**

Declare under our sole responsibility that the product:

B1500 B1500A B1500E B1500YA

To which this declaration relates is in conformity with the following standard(s) or other normative document(s):
EN ISO 12100 EN ISO 3744 EN ISO 11202 EN ISO 5349-1 EN ISO 5349-2 EN55014-1/A11 EN 55014-2

Following the provisions of the UK Legislation(s):

S.I. 2008/1597 S.I. 2012/3032 S.I. 2016/1091



CEMBRE

Felice Albertazzi
CHIEF SALES & MARKETING OFFICER
Cembre S.p.A.

Brescia 27-10-2022





www.cembre.com

CEMBRE S.p.A.
via Serenissima, 9
25135 Brescia
Italy
Ph +39 030 36921
ufficio.vendite@cembre.com
sales@cembre.com

CEMBRE Ltd.
Dunton Park,
Kingsbury Road,
Curdworth, Sutton Coldfield
West Midlands, B76 9EB
United Kingdom
Ph +44 01675 470440
sales@cembre.co.uk

CEMBRE S.a.r.l.
22 Avenue Ferdinand
de Lesseps
91420 Morangis Cedex
France
Ph +33 01 60 49 11 90
info@cembre.fr

CEMBRE España S.L.U.
Calle Verano 6 y 8
Pl Las Monjas
28850 Torrejón de Ardoz
Madrid - Spain
Ph +34 91 4852580
comercial@cembre.com

CEMBRE GmbH
Geschäftsbereich
Energie- und Bahntechnik
Heidemannstr. 166
80939 München
Germany
Ph + 49 89-3580676
info@cembre.de



CEMBRE GmbH
Geschäftsbereich
Industrie und Handel
Boschstraße 7
71384 Weinstadt
Germany
Ph +49 7151-20536-60
info-w@cembre.de



CEMBRE Inc.
Raritan Center Business Park
300 Columbus Circle-S.F.,
Edison, NJ 08837 USA
Ph +1 (732) 225-7415
sales.us@cembre.com
Midwest Office
1051 Perimeter Dr #610
Schaumburg, IL 60173